



Automation Engine: Controller (eBCON)

Description

The enteliBUS Controller (eBCON) is a fully programmable native BACnet® Building Controller. The Controller supports multiple communications methods including, as standard, BACnet/IP, BACnet over Ethernet, BACnet MS/TP and Delta LINKnet.

The Controller integrates the functions of the enteliBUS Manager and the enteliBUS Expander into a single compact module. This single module contains the primary CPU, memory storage, external communication ports, and direct I/O control for up to 4 enteliBUS I/O Modules.

The eBCON comes bundled with a Controller backplane that holds up to 4 I/O modules. A connector on the backplane allows you to connect up to 8 backplanes (and associated I/O modules), all of which can be controlled from a single eBCON.



Application

Used together with enteliBUS I/O modules, the eBCON is a small footprint controller perfect for applications with limited mounting space. It can be expanded with additional backplanes/modules for high density I/O applications.

The eBCON can also be used as an intelligent controller for a Delta access control system. The eBCON contains enough memory to hold 50,000 card user database, and can manage up to 24 single- direction doors when used with 12 ADM-2W704 controllers.

Features

- ▶ Native BACnet firmware
- ▶ Fully programmable in GCL+
- ▶ BACnet Ethernet, BACnet/IP, and BACnet MS/TP communication ports
- ▶ Modular, expandable I/O
- ▶ Advanced fault detection & diagnostics
- ▶ SD card memory expansion
- ▶ Firmware upgrade & database load/save over the network
- ▶ LED status indications of power/scan and communication ports
- ▶ Small footprint, DIN rail mountable
- ▶ Modular design provides flexibility, ease of service, and reduced cost for future upgrades

Specifications

BACnet Device Profile

BACnet Building Controller (B-BC)

Mounting

Backplane: Snap mounts to standard 35mm DIN rail
eBCON: Snap mounts to Backplane & DIN rail assembly

Device Type/Addressing

Software addressed

Connectors

Removable screw-type terminal connectors

Wiring Class

Class 2 / SELV

Power

24 VAC 50/60 Hz @ 6 VA, 100 VA max with fully loaded I/O modules*

*eBCON supplies power for up to 4 I/O modules via the Controller backplane

enteliBUS is a registered trademark of Delta Controls Inc.
BACnet is a registered trademark of the American Society of Heating, Refrigerating and Air Conditioning Engineers Inc.

Updated April 2016

enteliBUS®

eBCON: Layout

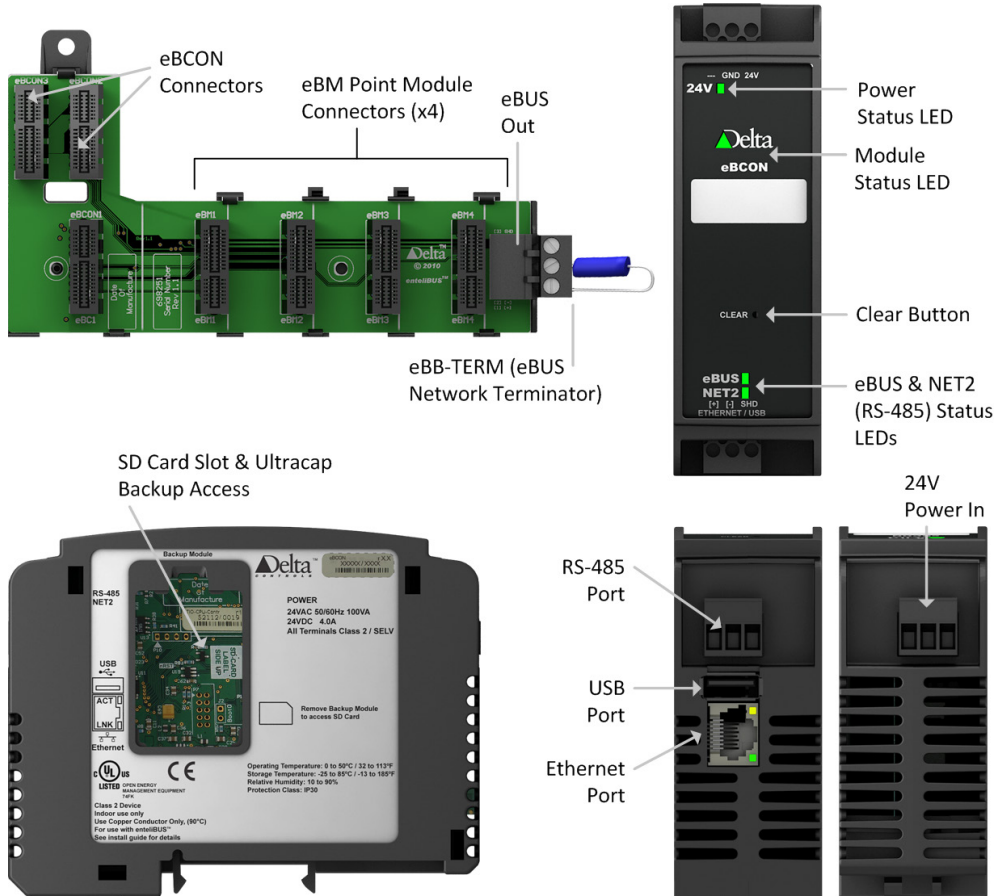

Specifications (Continued)

Technology

ARM9 32-bit RISC CPU
 64 MB Flash memory
 32 MB SDRAM memory
 SD/SDIO card slot for memory expansion
 Real-time clock (temperature compensated)
 Ultracap power backup for RTC and memory

Communication Ports

Ethernet (10/100-BaseT)
 BACnet/IP, BACnet over Ethernet

RS-485 Port supporting:

BACnet MS/TP up to 76800 bps, max 99 devices per port

Delta LINKnet up to 76800 bps, max 12 devices on LINKnet with no more than 2 DFM devices

USB Host Port

Ambient

32° to 131°F (0° to 55°C)
 10 to 95% RH (non-condensing)

Dimensions

5.0 x 5.7 x 4.0 in.
 (12.6 x 14.5 x 10.0 cm)**

**Dimensions given are for eBCON package with Controller backplane

Weight

0.820 lb (372 g)

Enclosure Protection Rating

IP30

Compliance

CE
 FCC

Listings

UL 916 Listed
 UL 864 Listed for UL 864 product numbers
 BTL Listed

Subject to change without notice.

Ordering

Order the eBCON according to the following product number:

eBCON	enteliBUS Controller w/ 4-slot Controller backplane
eBCON-UL864-340	enteliBUS Controller w/ 4-slot Controller backplane, UL 864 Listed

Accessories

See enteliBUS parts list for a complete list of all available enteliBUS modules and accessories.

eBM-D400	enteliBUS I/O module with 4 digital inputs and 4 relay outputs
eBM-D800	enteliBUS I/O module with 8 digital inputs†
eBX-04	enteliBUS expander—I/O expander with 4-slot expander backplane†
eBX-08	enteliBUS expander—I/O expander with 8-slot expander backplane†
eBMGR	enteliBUS manager—CPU/Comm. module†
eBMGR-TCH	enteliBUS manager—CPU/Comm. module with touchscreen LCD
eBM-440	enteliBUS I/O module with 4 universal inputs and 4 0-10 VDC outputs†

† UL 864 versions available